

Multifunctional Aluminum Alloy Paint Curing Lamp NT13-1H

OPERATION MANUAL



**ONE
TECH**

ONETECH

Tools

PLEASE READ THIS OPERATION MANUAL CAREFULLY BEFORE USING THE EQUIPMENT AND REFER TO IT AS NEEDED TO ENSURE THE CONTINUED SAFE EQUIPMENT OPERATION.

THIS OPERATION MANUAL SHOULD BE READ COMPLETELY BEFORE ATTEMPTING TO USE OR SERVICE THE EQUIPMENT. FAILURE TO FOLLOW THE INSTRUCTIONS IN THIS MANUAL COULD RESULT IN PROPERTY DAMAGE, SEVERE PERSONAL INJURY, OR DEATH.

THE SAFETY ADVICE IN THIS MANUAL IS IN ADDITION TO, AND DOES NOT REPLACE, THE GENERAL SAFETY REGULATIONS IN FORCE IN THE REGION WHERE THE EQUIPMENT IS OPERATED.



➤ Magnetic fields can affect pacemakers. Pacemaker wearers keep away from the equipment. Wearers should consult their doctor before going near equipment operations.

➤ Do not touch any live electrical parts. Wear dry, hole-free insulating gloves and body protection. The input power circuit and machine internal circuit are live with high voltage when power is on. Touching live electrical parts can cause fatal shocks or severe burns. High voltage exists in the power supply socket. Never touch the conductor terminals with bare hand.



➤ Never disassemble, repair, alter or rebuild the equipment without approval from the manufacturer. There is a risk of electrical shock or fire.

➤ Do not operate or place the device near water or in wet locations. Risk for electrical shock or damage to the device.

➤ Replace power cord/wire/cable immediately bare wiring can kill.

➤ Frequently inspect input power cord and regularly clean the unit to remove dust and dirt. Any worn or damaged power cord or internal components in heavy dust may cause electrical shock, short circuit or fire.

- Electric shock can kill. Properly ground this equipment according to its user manual and national standard.
- The equipment must be used by qualified personnel familiar with electronic equipment.
- Input power installation must meet national standard. All electrical connections must be made by a qualified electrician. Insulated gloves and shoes must be worn when connecting input power or maintaining equipment.
- In the event of abnormal, operation must be immediately stopped. If smoke, smell or abnormal noise is produced by the unit, disconnect the power cord immediately and contact your local dealer. Do not use it until the problem is fixed.
- Use only well-maintained device. Inspect and maintain the device for safety every 12 months, including cleaning and removing dust. Repair or replace damaged parts/cables at once.
- Make sure the supply cable is up to national standard or local code. Use only the right gauge of electrical wire/cable. There is a risk of fire or electrical shock if overload building wiring be sure power supply system is properly sized, rated and protected to handle this unit.
- Do not step on, twist or pull the power cord.
- Frequently inspect input power cord and regularly clean the unit to remove dust and dirt. Any worn or damaged power cord or internal components in heavy dust may cause electrical shock, short circuit or fire.
- Do not operate the equipment in potential hazardous areas: chemicals, oil, gas and mining, or the worksites where power supply system is in poor condition.
- The equipment is designed for curing paint only. Do not use the equipment for other purposes. This may cause fire or electrical shock.
- Never place any materials/objects on top of the equipment to avoid fire and electrical shock.
- Do not locate equipment on, over, or near combustibles.
- Use only the spare parts supplied or approved by manufacturer.
- Do not place the equipment on unstable or uneven ground. The equipment might fall causing injuries and damage to the equipment. During operation process, the equipment should keep a distance about 10 cm from the wall to keep air way clear.

- Avoid using the equipment in the environments with high humidity (above 90%), high temperature (above 40 °C), low temperature (below 5 °C), high frequency source nearby, chemical and drug, water vapor for condensation, dust or vibration.
- Make sure the facility supply voltage and frequency are the same as shown on the nameplate. The supply cable must be properly sized and rated.
- The connection between the main power supply and the equipment should be as short as possible.
- Use a dry cloth to clean the dirt on the equipment.
- Follow the instructions of this user manual to operate the equipment.
- We have made installation and operation quick and easy. Please operate the buttons and switches gently with your hands, only one button each time. The sensitive control circuit will be damaged if pressing the buttons with hard or sharp thing such as screwdriver or pen.
- Turn off all the equipment when not in use.
- Follow the installation and operation instruction to ensure user safety and proper equipment performance. It is the responsibility of the owner to ensure that the equipment has been installed and operated as specified in the provided instructions. The manufacturer takes no responsibility for any loss or damage made because of using the equipment incorrectly or improperly.

MAINTENANCE

- Never disassemble, repair, alter or rebuild the equipment without approval from the manufacturer.
- Use only well-maintained device. Inspect and maintain the device for safety every 12 months, including cleaning and removing dust. Repair or replace damaged parts/ cables at once.
- Use only the spare parts supplied or approved by manufacturer.
- Do not forget to take back all repair tools/objects inside the equipment after repair/ maintenance, such as screws, bolts or nuts. The left out metallic objects inside the equipment can cause damage to the equipment.

STORAGE

- Avoid storing the instrument in conditions of high humidity.

ITEM DESIGN HANGE

It is forbidden to make changes to the design of the tool without the consent of the manufacturer.

DISPOSAL

When disposing of the tool or individual components, observe the local regulations in force in the region of the equipment usage.

TECHNICAL SPECIFICATION

Model	Input Power, W	Curing Area, mm	Temperature, °C	Time Setting, min	Light Intensity, %	Curing Distance, mm	Input Voltage
NT13-1H	1100	800 × 500	40 - 75	0 – 60 adjustable	100	200 - 1200	220V, 50-60Hz

OPERATING

- Set curing time according to the requirement of paint for curing.
- To achieve the best effect, the emitters should be parallel with the paint surface. Keep distance of 30-60 cm away from the panel.
- During the process of curing, the paint surface must be clean without water and impurities.
- Switch on the power supply and set up the curing time to start curing process.
- Turn off the equipment after using. Place the equipment in a safe place to avoid damage to the lamp.

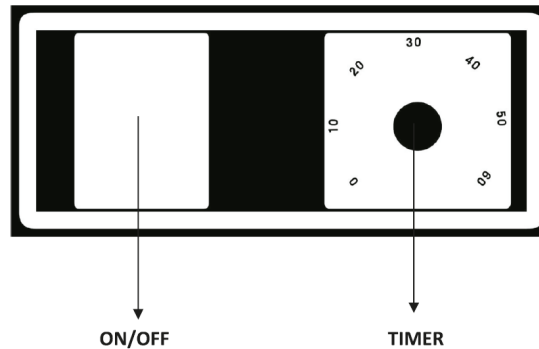

TROUBLESHOOTING

PROBLEM	CAUSE	SOLUTION
Light tube does not work	<ol style="list-style-type: none"> 1. Light tube damaged 2. Lamp is not plugged in 3. Control silicon damaged 	<ol style="list-style-type: none"> 1. Check light tube 2. Check the connections 3. Check control silicon
Light tube does not turn off	Control silicon damaged	Check control silicon
Digital display is blank or incomplete	<ol style="list-style-type: none"> 1. Unplugged flat wire in circuit board 2. Digital display damaged 	<ol style="list-style-type: none"> 1. Check flat wire 2. Check digital display
Temperature and time cannot be adjusted	<ol style="list-style-type: none"> 1. Switch imbalance 2. Key board has exclusion 	<ol style="list-style-type: none"> 1. Check the installation of switch 2. Check keyboard exclusion

LIGHT TUBE REPLACEMENT

- Prepare the cassette that needs replacement.



- Remove the grille of cassette.



- Remove the plates from both ends of the cassette.



- Remove the fixed plates from both ends of the cassette.



- Loosen fixed screws and cut off connections, the light tube can be replaced.



- Repeat the steps above in reverse order to replace the light tube.



ELECTRICAL SCHEMATIC

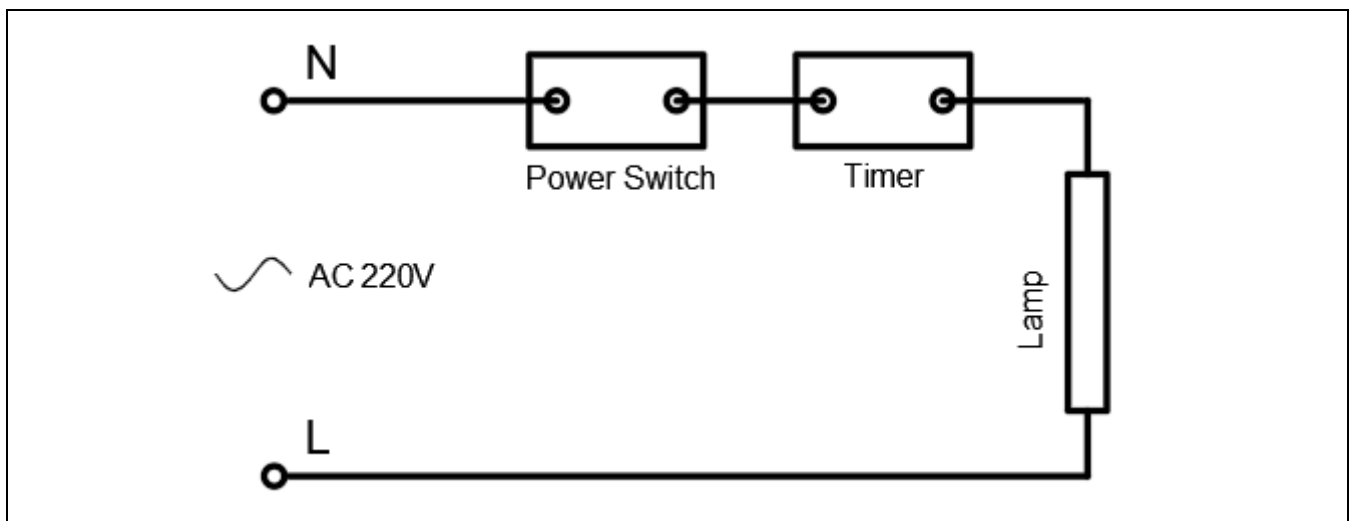

Parts

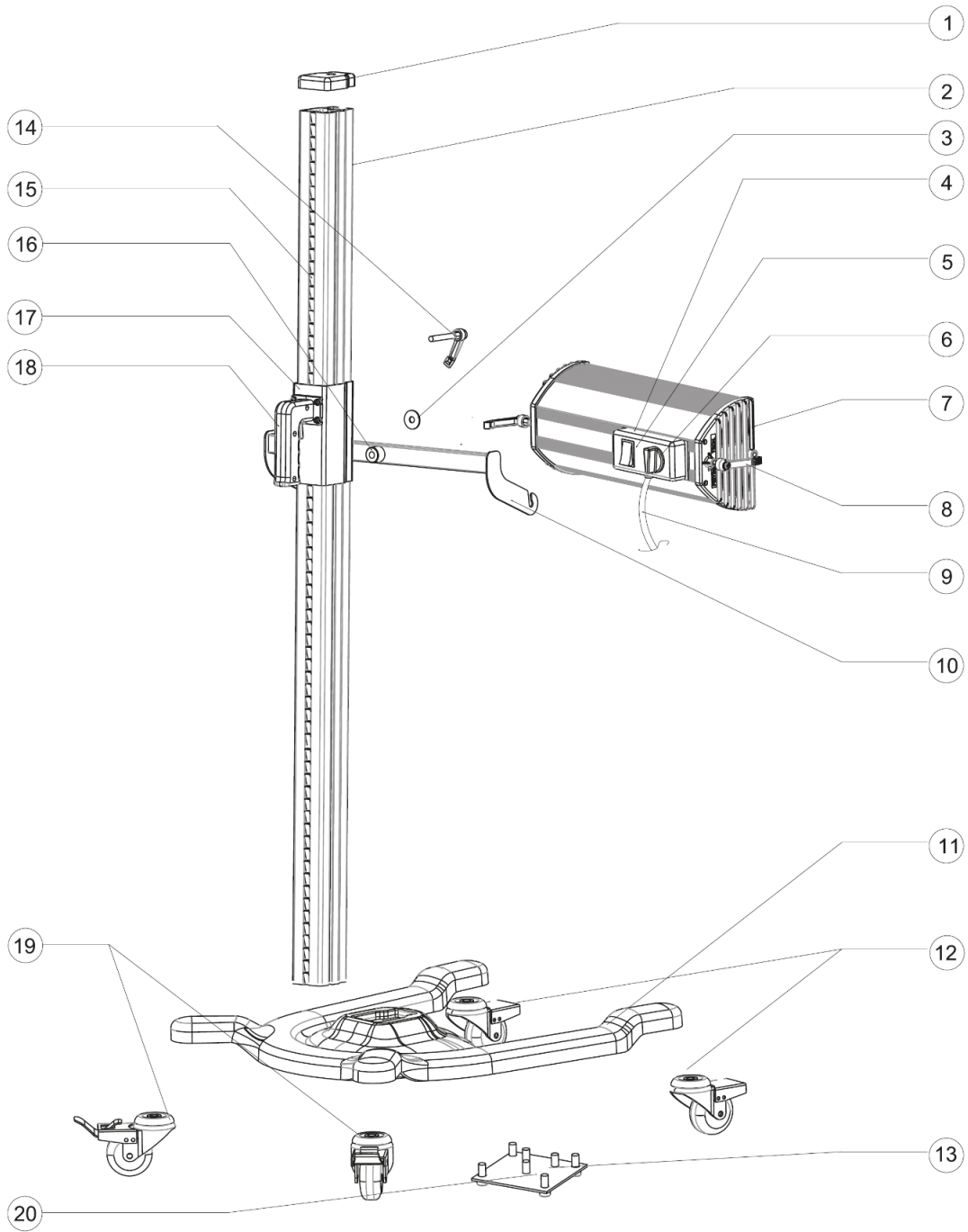

No.	Description	Part No.
1	Top cover	NT13S-033
2	Upright post	NT13S-034
3	Washer for cassette	NT13S-035
4	Control box	NT13S-036
5	Power switch	NT13S-037
6	Timer	NT13S-038
7	Cassette	NT13S-027
8	Lock handle	NT13S-026
9	Power cable	NT13S-041
10	U-bracket	NT13S-042
11	U-type base	NT13S-043

No.	Description	Part No.
12	Front caster	NT13S-044
13	Fixing plate	NT13S-045
14	Lock Handle	NT13S-046
15	Ratchet	NT13S-047
16	Anti-slip washer	NT13S-048
17	Adjustment mechanism	NT13S-049
18	Handle	NT13S-050
19	Back wheel	NT13S-051
20	M8 screw	NT13S-052
21	Light tube (not shown)	NT13S-053



info@onetech-tools.com



www.onetech-tools.com

